



A single machine provides case erecting, packaging, and case closing

Ishida ACP minimizes operator intervention and improves productivity in any type of production condition, such as single mass production, high-mix and low-volume production.

High speed, high quality

Supports a wide variety of products

Easy change over

High-speed case packaging provided by an integrated system that spans case erecting to case closing. Continuous high-quality case packaging regardless of the operator's skill level.

A single machine can handle a wide variety of bag formats and case packing formats. Provides cost reduction within in-store display operations and transportation.

Changeover is initiated by simply pushing a button; the process is toolless and minimizes production downtime.

Dimensions (Unit: mm)  
ACP-702-1179-TT

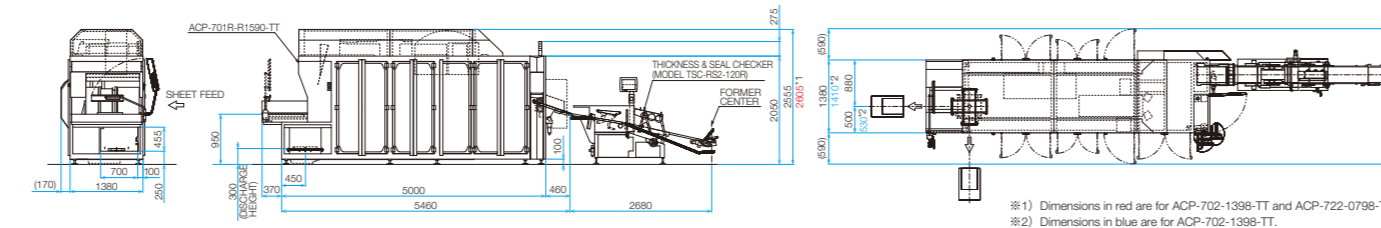

ACP-712-1898-NN

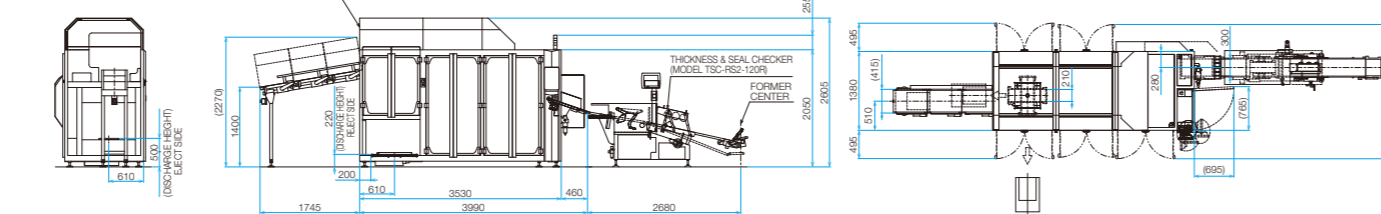

Standard specification

Model	ACP-702-1179-TT	ACP-702-1398-TT	ACP-712-1898-NN	ACP-722-0798-TT	RRP
Type	Small Case	Standard Case	Load Only	Standard Case	
<b>Performance</b>					
Bag Size <sup>1)</sup>					
Width			108-330mm		
Length <sup>2)</sup>			120-375mm		
Thickness			22.5-120mm		
Weight			20-1000g		
Case Size					
Width	250-350mm	275-415mm	300-415mm	275-415mm	140-275mm
Length	350-600mm	375-620mm	400-620mm	375-620mm	300-415mm
Height	125-375mm	125-381mm	145-381mm	160-381mm	160-381mm
Flap Length	125-175mm	137-207.5mm	150-207.5mm	137-207.5mm	70-137.5mm
Case Direction	Right hand case or left hand case (choose one or the other)				
Case Type	Slotted boxes				
Thickness	3mm-5mm (C flute recommended)				
Pack Pattern	Stand-up (major·minor) Side-pack (major·minor) <sup>3)</sup>				
Bag Speed <sup>4)</sup>	150bpm				
Tape Width	48mm				
Tape Core Diameter	Max φ 300mm	Max φ 320mm	Max φ 300mm	Max φ 320mm	
Case Speed <sup>4)</sup>	10case/min		10case/min	10case/min	20case/min
HMI	15.6" sized color LCD touch panel				
<b>Specification</b>					
Power Supply <sup>5)</sup>	Three Phase 380, 400, 415, 440, 480V				
Air Consumption	550litres/min (ANR) max 0.5MPa		440 L/min(ANR) max 0.5MPa	1200litres/min (ANR) max 0.5MPa	
Ingress protection	IP 30 <sup>6)</sup>				
Operational environment	Temperature 0~40°C				
Humidity	30~70%RH (without dew condensation) <sup>7)</sup>				
Weight	Approx.3500kg		Approx.4000kg	Approx.4000kg	

<sup>1)</sup> Running condition will depend on bag speed, case size, pack pattern, bag weight and product type/volume. Ratio of bag width, length and air fill also affect the running condition.  
<sup>2)</sup> When running side pack (option), bag length is 120 - 400mm <sup>3)</sup> Optional  
<sup>4)</sup> Running speed will depend on the bag and case size, sheet strength, sheet dimension tolerance, film material, pack pattern, case printer, and case turning function on case discharge conveyor  
<sup>5)</sup> Voltage fluctuation: within ±10% <sup>6)</sup> Based on internal test results <sup>7)</sup> Maximum 85% (option)

The information in this catalog is current as of 25 May 2023.  
 The company name and product name described in this catalog are registered trademarks.  
 The machine color in this catalog might be differ from the real machine.  
 The described machine appearance and specifications in this catalog are subject to change without any notification.

**ISHIDA**  
**ISHIDA CO., LTD.** www.ishida.com  
 44 Shogoin Sannocho, Sakyo-ku,  
 Kyoto, 606-8392, Japan  
 Tel: +81 (0)75 751 1618 Fax: +81 (0)75 751 1634



Automatic Case Packer

# ACP-700 series



Unequaled productivity provides solutions to workforce shortages

## ACP-700 series



## Compact and small footprint

Case erecting and closing operations are divided into upper and lower sections in the machine, case packaging is adjacently located. This integration results in a machine that is optimally compact.

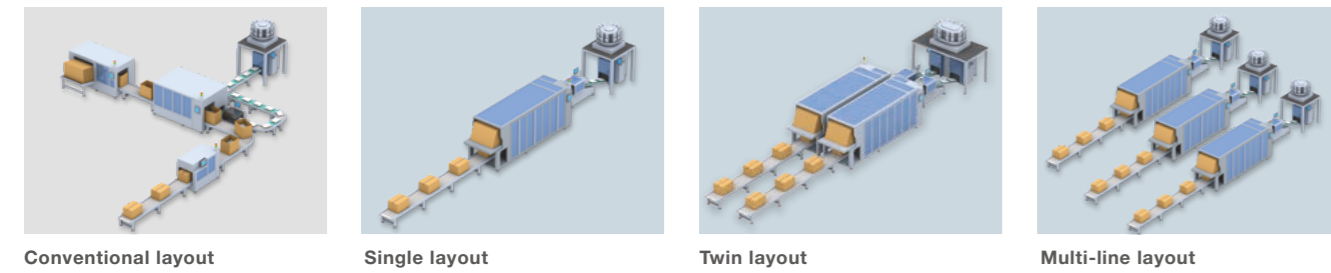
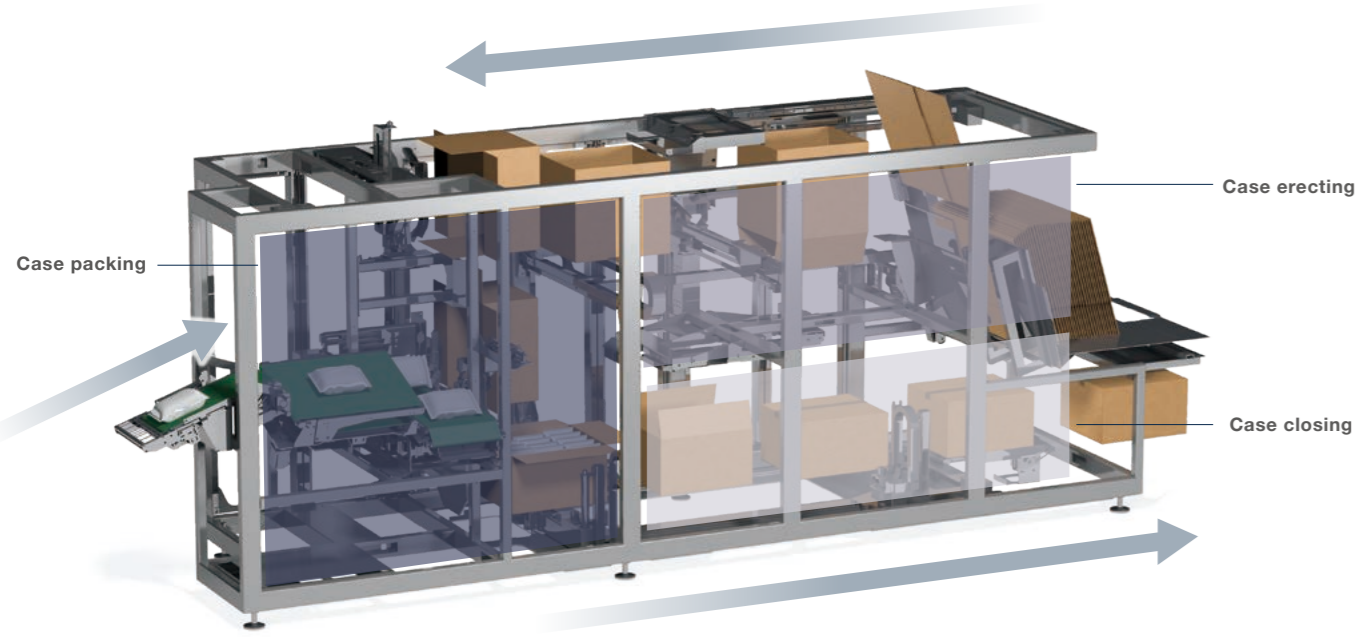

Ishida ACP can fit in a small space, and it has operational flexibility in various situation, such as existing machine replacement, line expansion, and layout change. Its moving route is smooth to optimize operation.

## High productivity and precise packing

Seamless design from case erecting to case closing contributes high productivity which maintains precise packing regardless of the operator's skill and experience.



## Flexible pack patterns and formats

A single machine can handle various sizes of packs/cases and pack patterns.

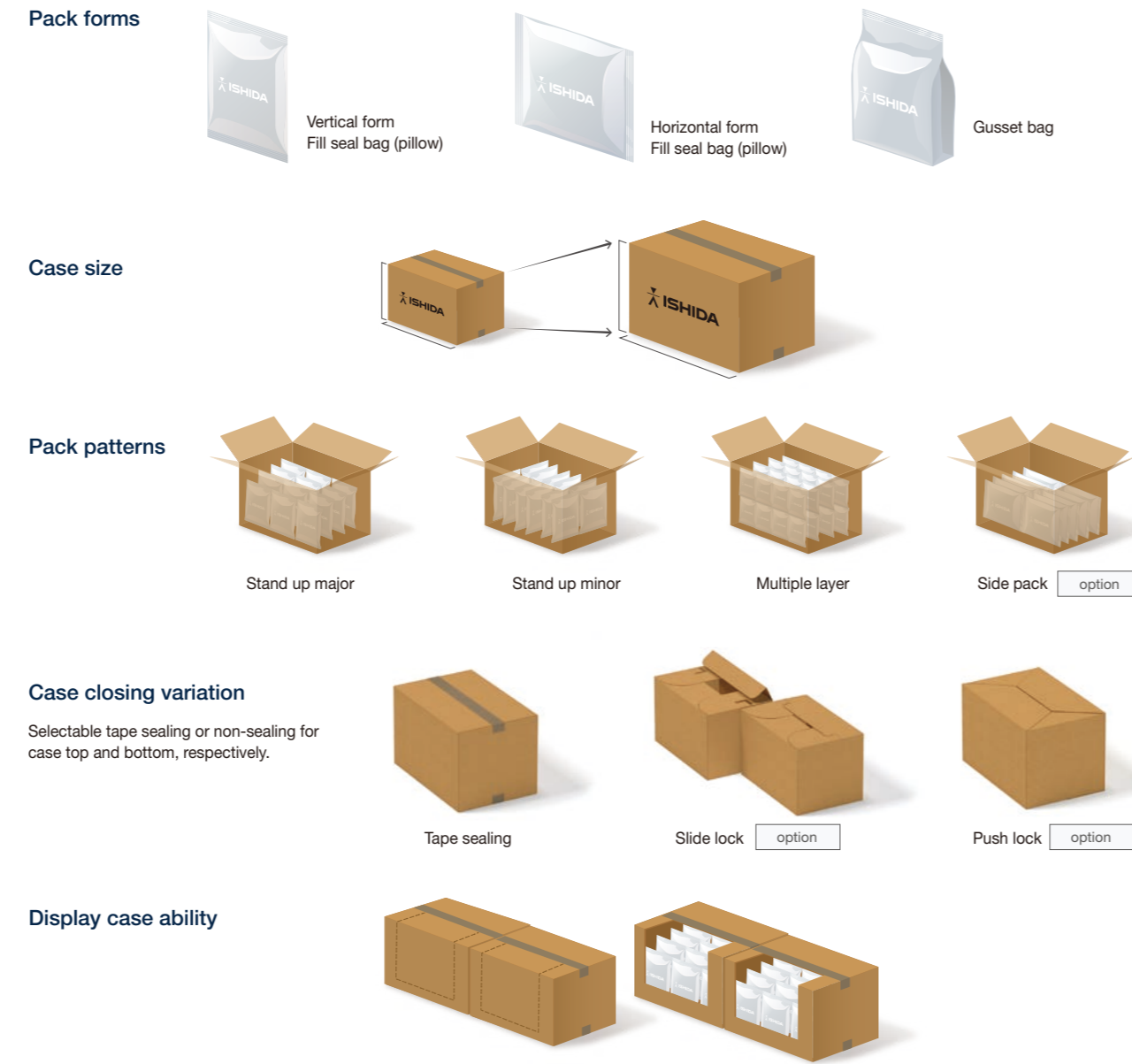

## ACP-722 Retail ready packaging (RRP)

The RRP model has the capability of packing not only standard size cases but also small and narrow cases which are used for direct shelving. It can suit a wider range of requirements from retail stores.



### One button changeover

Able to switch from conventional case to RRP case in one touch

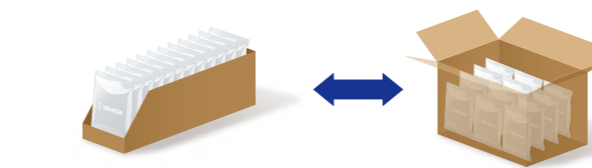

### RRP model case rate capability



## ACP-712 load only

The load only machine is designated to put packs into the case. A third party's case erecting/closing equipment can be interfaced with the load only ACP for the case closing process. Also hand closed cases can be fed to the load only ACP.



## Easy and quick set up

The operator can simply select the preset on the screen and the machine will be automatically set up without any tools. Operator skill is not required to set up and start the production.

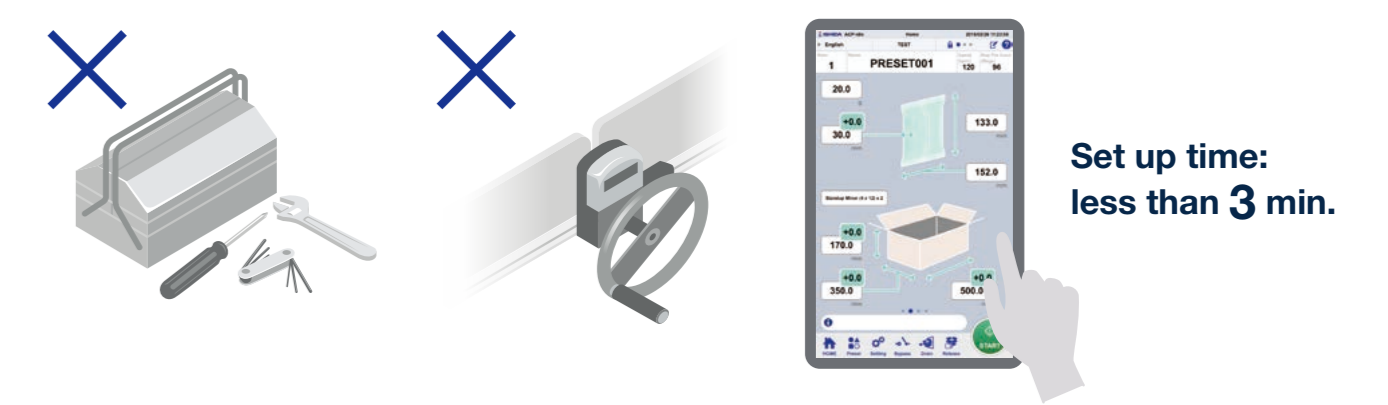

## Advanced HMI

A smart phone-like HMI (15.6-inch) is included with the machine. It is intuitive and is easy to operate.

### Function to maintain smooth production

Easy to verify current production information such as production status, machine statistics, material usage, operation log and maintenance indication. Also, the troubleshooting guidance supports operators to recover the machine quickly.



## TSC Thickness and Seal checker

Precise inspection of air leakage and pack thickness for efficient case packing performance.

A servo motor sensor detects air leakage and measures pack thickness accurately. Quality controlled packs lead to case packer's stable performance. In addition, "Feed forward" function tells the thickness of each pack to Ishida ACP, which optimizes the bag loading condition automatically.



## Cost benefit of packing material and logistics

The machine can be applied to a wide variety of packing methods, bag counts, and case sizes, additionally, it can reduce the number of corrugated boxes used, providing opportunity for material cost review. Reviewing corrugated box sizes also leads to improved loading efficiency on pallet, contributing to lower transportation costs, and further reduction of CO<sub>2</sub> emissions. Ishida ACP flexible capabilities minimizes the amount of case usage and the cost of materials.

## Solution to cope with various demand from retailers

Ishida ACP supplies solutions to satisfy any kind of retailers needs.

- Ease of Shelving
- Case size
- Pack format
- Case type